

# RE.0444L - Light



- Applications**
- Industry
  - Speed control & regulation
- Features**
- Compact design
  - Good quality signal
  - DIN connector



## MOUNTING FORM

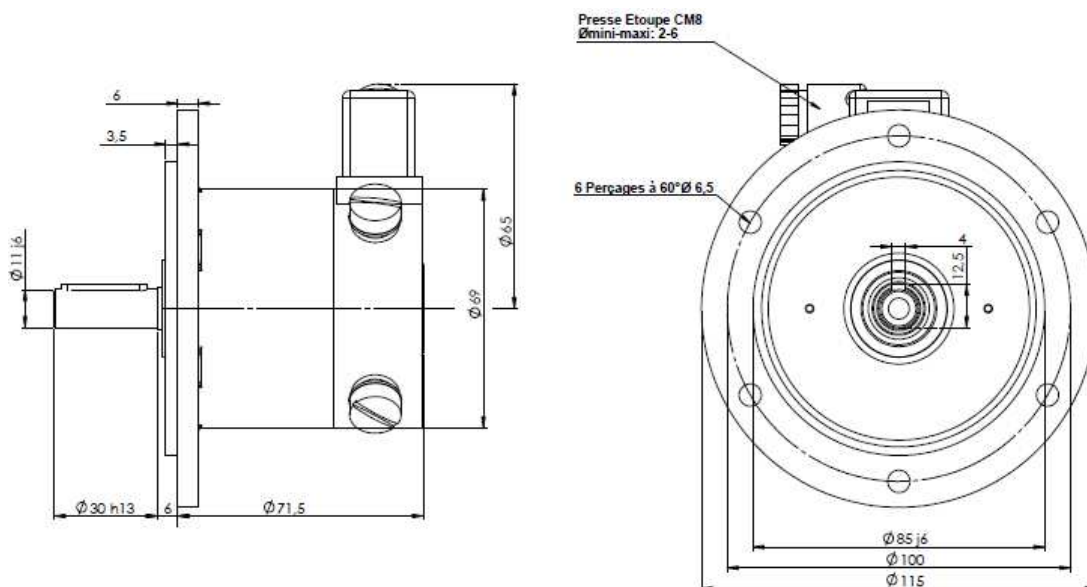

## MAIN CHARACTERISTICS

DESCRIPTION	SYMB	VALUE	CONSTRUCTION DETAILS	
Max. speed	$n_m$	8 000 rpm	Number of poles	4
Moment of inertia		0,62 Kg cm <sup>2</sup>	Armature slots number	33
No-load driving torque	$M_r$	0,4 N.cm	Commutator blades number	33
Max. radial shaft stress			Insulation class	(IEC 34-1)
7x30 mm	F	0,4 da N	Operating temperature	-20 +80 °C
11x30 mm	F	1,0 da N	Climatic protection	C <sub>a</sub> (IEC 68-1)
Maximum E.M.F.	$E_m$	300 V	Ingress protection	IP44 (IEC 34-5)
Maximum linearity error	$\Delta E$	$\leq 0,15 \% E_T$	Direction of rotation	reversible
Overall ripple rate (peak to peak)	$\Delta E_c$	$\leq 1 \% E_c$	Excitation	Permanent magnets - Samarium cobalt
Rotation harmonics (f=2 p.n)	$\Delta E_p$	$\leq 0,3 \% E_c$		
Slots harmonics (f=Z.n.)	$\Delta E_z$	$\leq 0,7 \% E_c$		
Calibration precision	$\Delta E_o$	$\pm 1,5 \% E_{T0}$		
E.M.F. temperature drift	$\Delta E_e$	0,03 %/°C		
Time constant	$C_t$	0,2		
Filter :				
Time constant of filter		1 ms		
Load current	$L_c$	3 mA		
Speed	n	3000 rpm		
			<b>Weight</b>	<b>1 kg</b>

# RE.0444L - Light

## MECHANICAL OPTIONS

	MOUNTING SIDE		
	D (mm)	L (mm)	Ball-bearing
Standard shaft	7	30	8 x 22 x 7 ZZ
	11	30	12 x 28 x 8 ZZ
Special shaft	14 max	30	15 x 32 x 9 ZZ



Markings and polarity of terminals (cables) for counter-clockwise rotation, seen from the shaft

A1 : +  
A2 : -

## ELECTRICAL OPTIONS

DESCRIPTION	SYMB	UNIT	VALUES
E.M.F at 1 000 rpm	$E_n$	V	<b>60</b>
Voltage gradient	$C_v$	V/rpm	0,06
Armature resistance	$R_a$	$\Omega$	160
Max thermal load	$I_{th}$	A	0,1
Max. Allowed speed	$n_a$	rpm	EG brushes
		rpm	CA brushes

## BRUSHES

GRADE	PART NO	MAX OUTPUT VOLTAGE	DIMENSIONS	QUANTITY
EG - Electrographite	/0011987	< 300 V	6 x 4 x 9,9 mm	4
CA - Silver-graphite	/0003341			

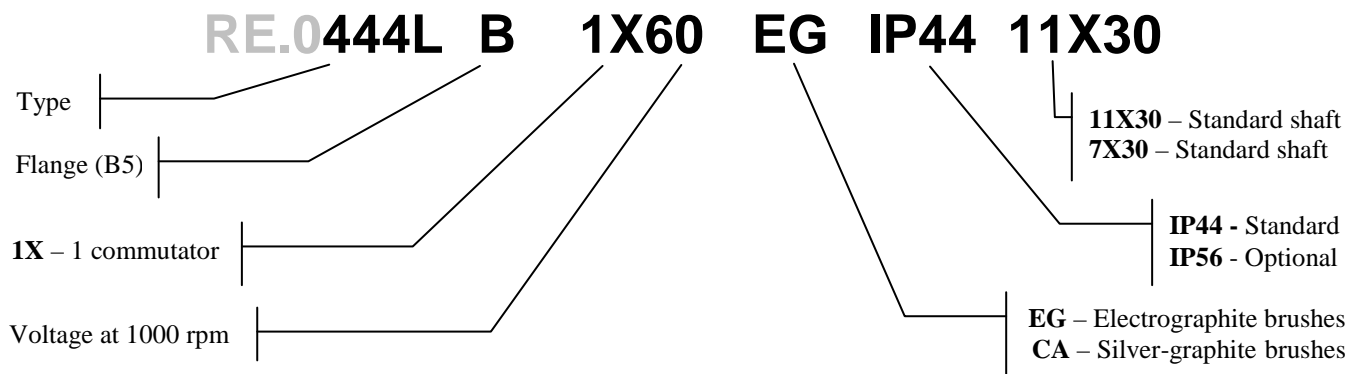

When inquiring, please advise the serial number of the tachogenerator to be replaced.